

Lot Size 6,600
 Approx Acres 0.15
 Electric Xcel Energy
 Water Town of Johnstown
 Gas Xcel Energy
 Taxes/Yr \$1,757/17
 Bedrooms 4
 Bathrooms 3
 Subdivision Rocksbury Ridge
 HOA \$240.00/Year
 Year Built 2003
 Style 2-Story
 Construction Wood/Frame, Stone
 Floors Carpet, Vinyl
 Heating Forced Air
 Cooling Central A/C

Inclusions: Window Coverings, Electric Range/Oven, Dishwasher, Refrigerator, Microwave

Schools
 Elementary Letford
 Elementary 2 Pioneer Ridge
 Middle/Jr. Milliken
 High School Roosevelt
 District Weld Re-5j

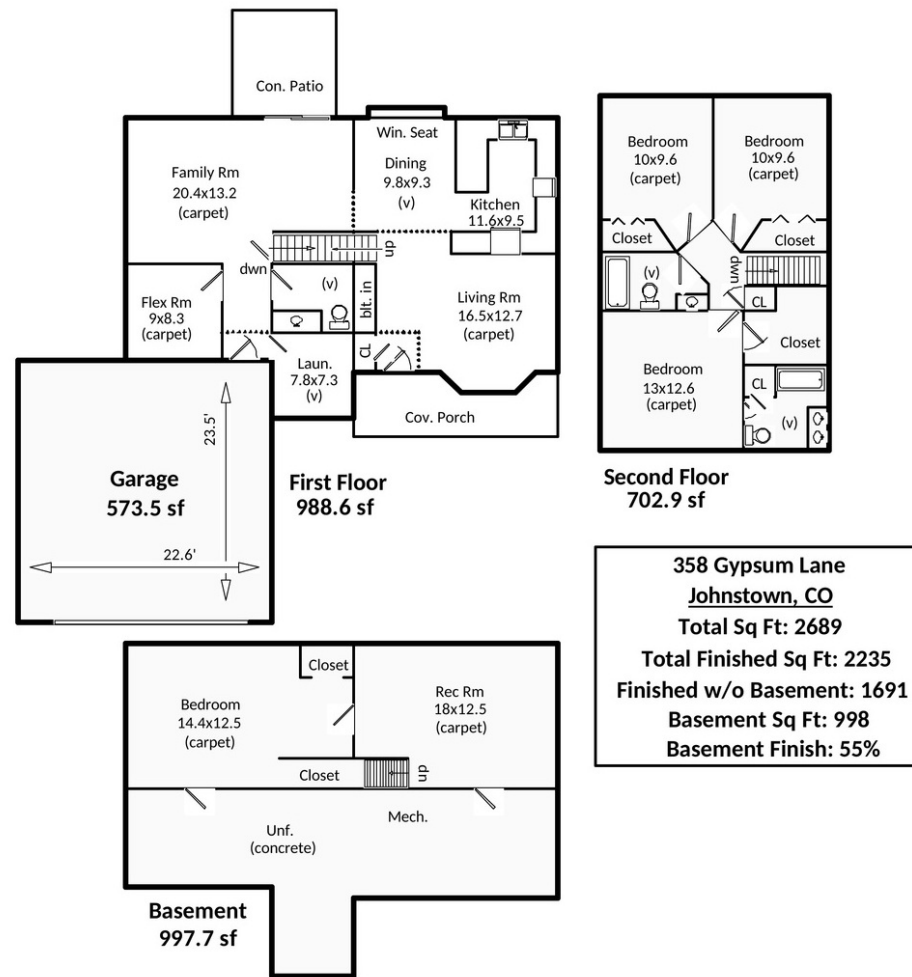

Information herein deemed reliable but not guaranteed. Distance and measurements are approximate and subject to correction. See our listings at www.thegroupinc.com. May 8, 2018



358 Gypsum Lane
Johnstown



Offered at
\$340,000

Joanne DeLeon

Broker Associate / Partner (970) 691-2501
 (970) 229-0700 office | jdeleon@thegroupinc.com | www.joannedeleon.com



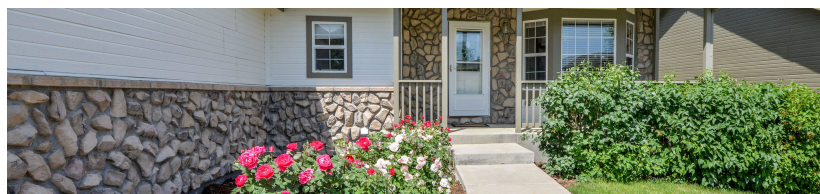

Home Is Like New!

Great for new owners! The roof and exterior paint are new with a transferable roof warranty. The carpet on the main and upper is new and basement was recently finished with large rec room and large bedroom. A bath can easily be the next addition! Wonderful home with 4 bedrooms, 3 baths and 2 car garage on a good sized lot (fully fenced backyard), has been updated in and out! Large living and family rooms open to the kitchen. Family room steps out to a quiet patio. The kitchen is spacious with ample cabinets, window seat, large eat-in and breakfast bar areas. Master has its own full bath and walk-in closet. Other 2 beds up are good sized and share a full bath. Out the door to Johnstown Reservoir, parks and trails!

