

1617 Cattail Drive, Loveland
\$340,000





Welcome Home!

Nicely updated ranch-style home, located in beautiful South-West Loveland. TONS of windows & lots of light throughout this open floor plan! On a large corner lot, this adorable home close to Cattail Pond has LOTS of updates to offer throughout. Updated kitchen and bathrooms. French doors lead to office. Basement is 90%+ finished. Move-in ready! Home has been pre-inspected!

Total SF 2,386 sf
 Lot Size 8,051 sf
 HOA Fees None
 Electric City of LV
 Water City of LV
 Gas Xcel
 Taxes/Yr \$1,452/2017
 Bedrooms 4
 Bathrooms 3
 Garage 2 Car Attached
 Subdivision Cattail Pond
 Year Built 1993
 Style Ranch
 Construction Frame/Brick
 Heating Forced Air
 Cooling Central Air

Room Sizes

Kitchen 11x11
 Living Room 18x14
 Dining Room 10x08
 Family Room 24x18
 Master Bedroom 15x10
 Bedroom 2 11x09
 Bedroom 3 11x10
 Bedroom 4 11x10
 Study 13x10
 Laundry 06x05

Schools:

Elementary Carrie Martin
 Middle Walt Clark
 High School Thompson Valley
 District Thompson R2-J

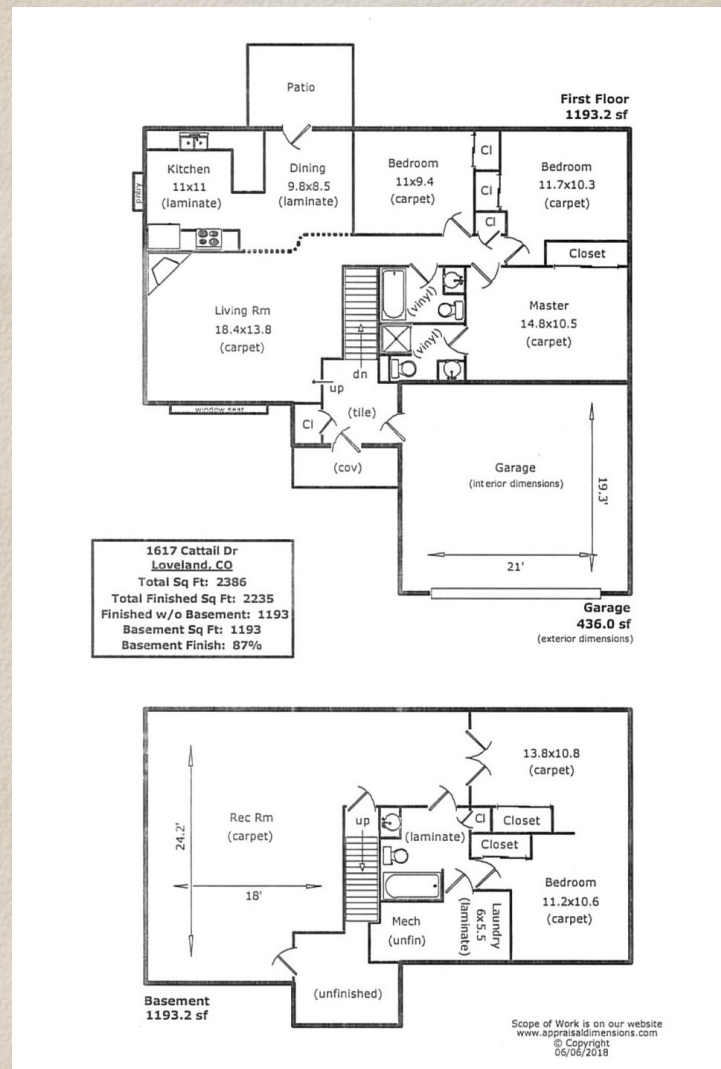

Mary Ann Michels

Broker Associate/Partner
 970-310-7944 Cell
 970-419-2341 Direct
 970-221-0700 Office
 mamichels@thegroupinc.com
 www.MichelsRealEstate.com

