

Desirable Derby Hill Location



**2641 Gaylord Drive
Loveland, Colorado 80537**

\$360,000



Kim Summitt
Broker Associate/Partner
(970) 689.6950 Cell
(970) 461.7142 Direct
(970) 663.0700 Office
ksummitt@thegroupinc.com

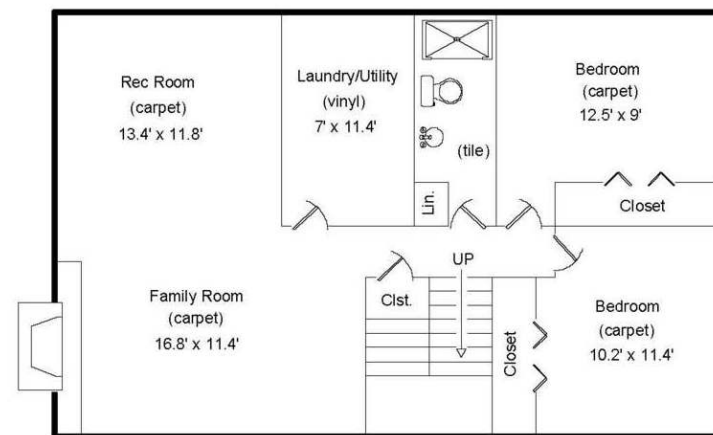
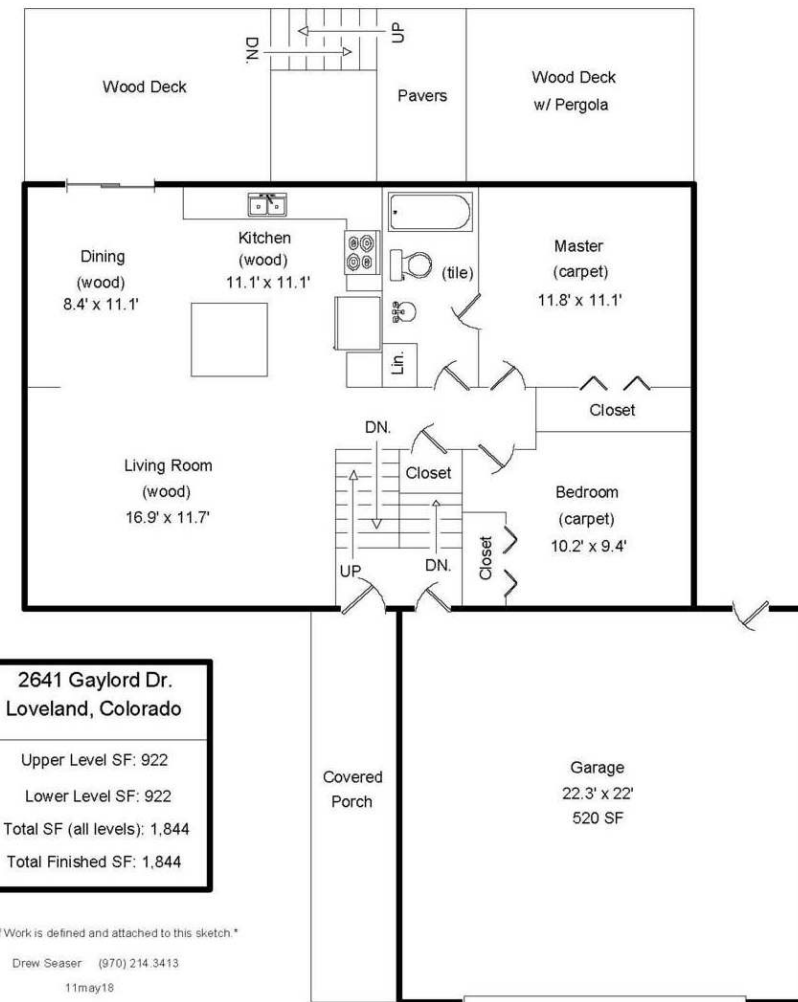

Electric City of Loveland
Water City of Loveland
Gas Xcel Energy
Taxes/Yr \$1,333/2017
Bedrooms 4
Bathrooms 2
Subdivision Derby Hill
Style Bi-level
Construction Brick, wood
Floors Carpet, wood
Heating Gas forced air
Cooling Central air, ceiling fan

Inclusions--Electric range/oven,
refrigerator, dishwasher,
microwave and window
coverings currently in place

Schools
Elementary Carrie Martin
Middle/Jr. Bill Reed
High School . Thompson Valley
District Thompson R2J

www.KimSummitt.com

Information herein deemed reliable but not guaranteed. Distance and measurements are approximate and subject to correction. See our listings at www.thegroupinc.com.





Check out the updates



*Updated home in SW
Loveland. Kitchen and
bathrooms updated
within last 4 years,
new cabinets, granite,
appliances and new
carpet in 2018. Large
fenced mature lot
includes play house,
storage shed and garden
area. New furnace
within last 5 years.*

This is a must see property